

Sensory Friendly Map of The Metropolitan Museum of Art for Visitors on the Autism Spectrum

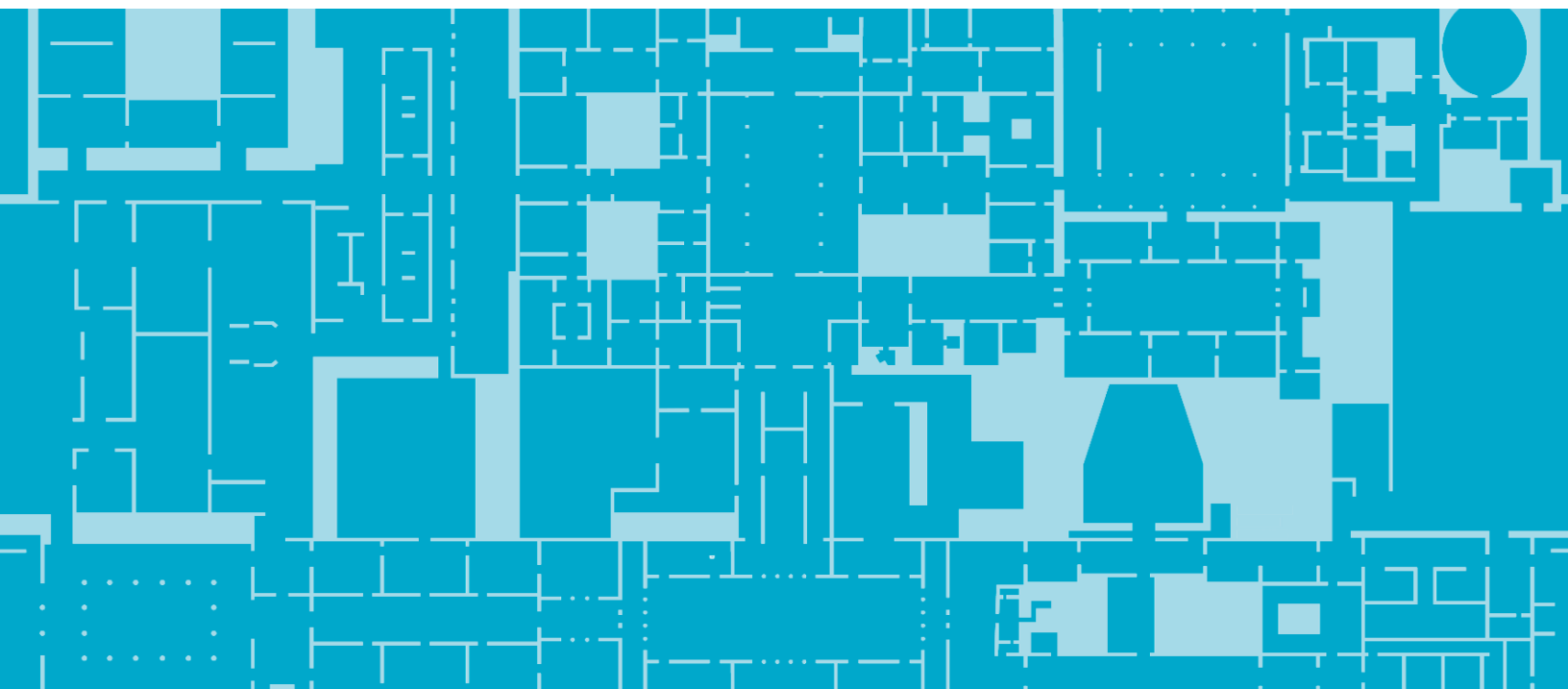

Sensory Friendly Map of The Metropolitan Museum of Art for Visitors on the Autism Spectrum

There are some spaces in particular within the Museum that you should be aware of during your visit. These spaces—some of which are quieter and less crowded and others that are overly stimulating—are indicated here. Use this tool as you design your [My Met Tour](#) (PDF) visual checklist and decide which spaces to visit and which to avoid.



Quiet and less-crowded spaces

1st floor

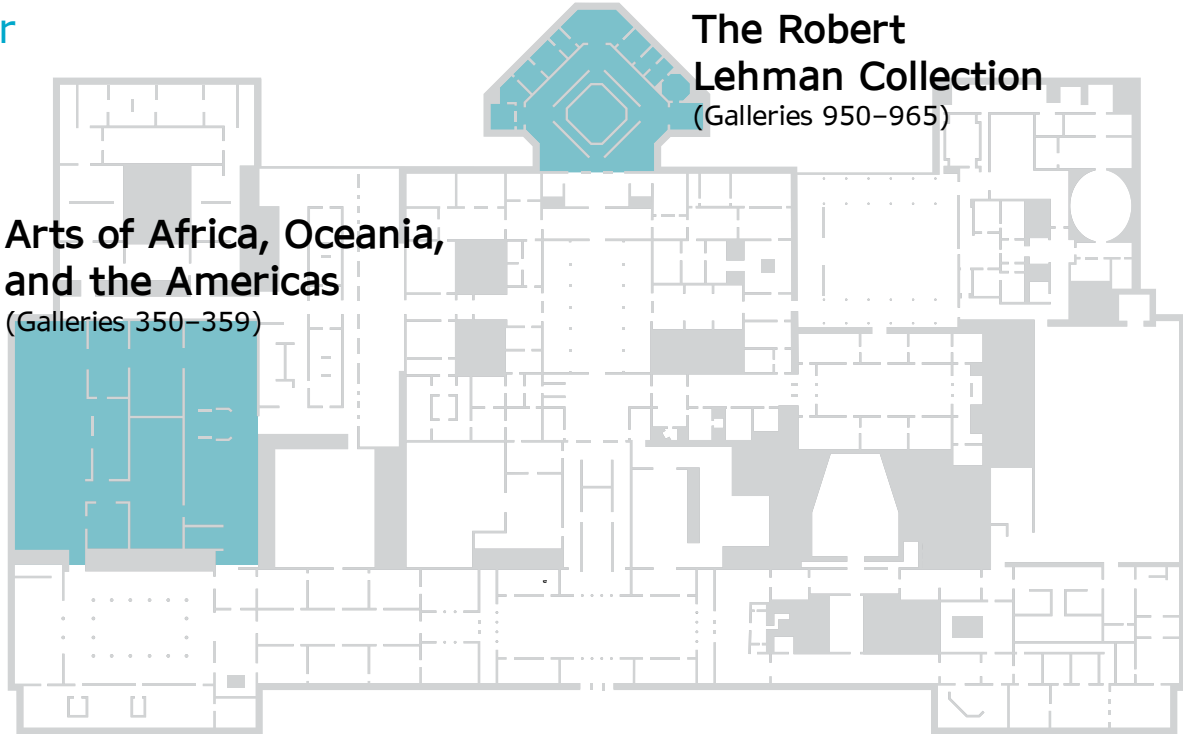

2nd floor

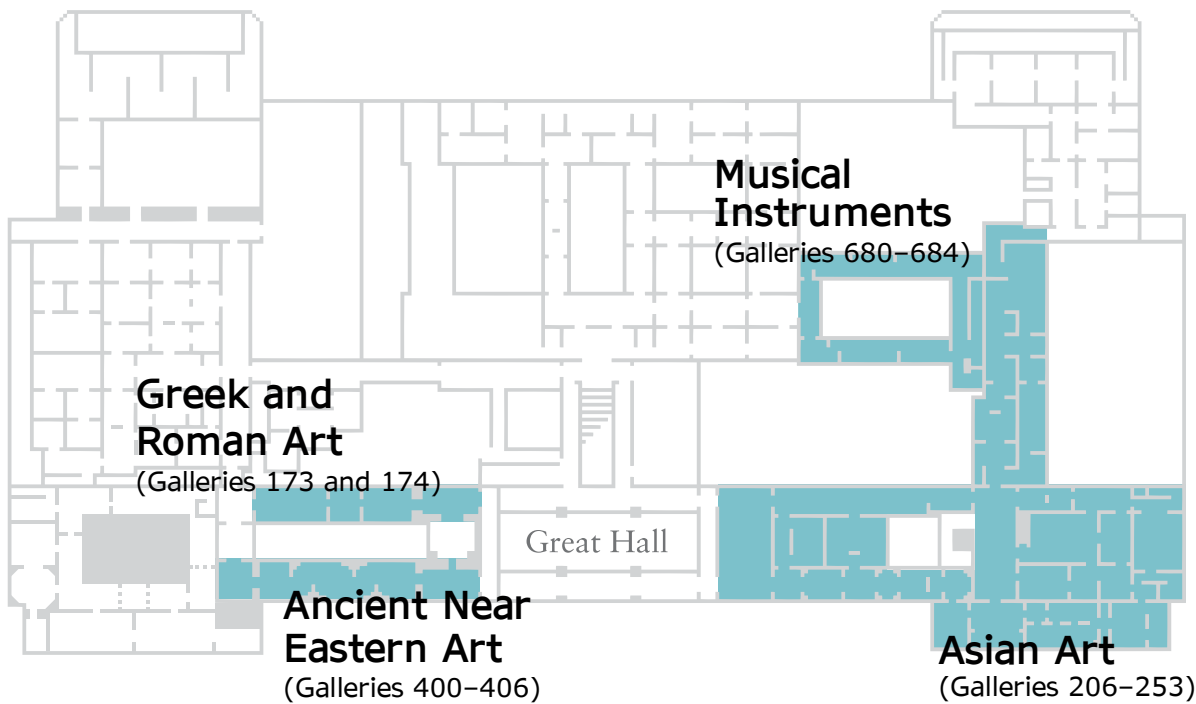

Spaces that tend to be crowded

1st floor

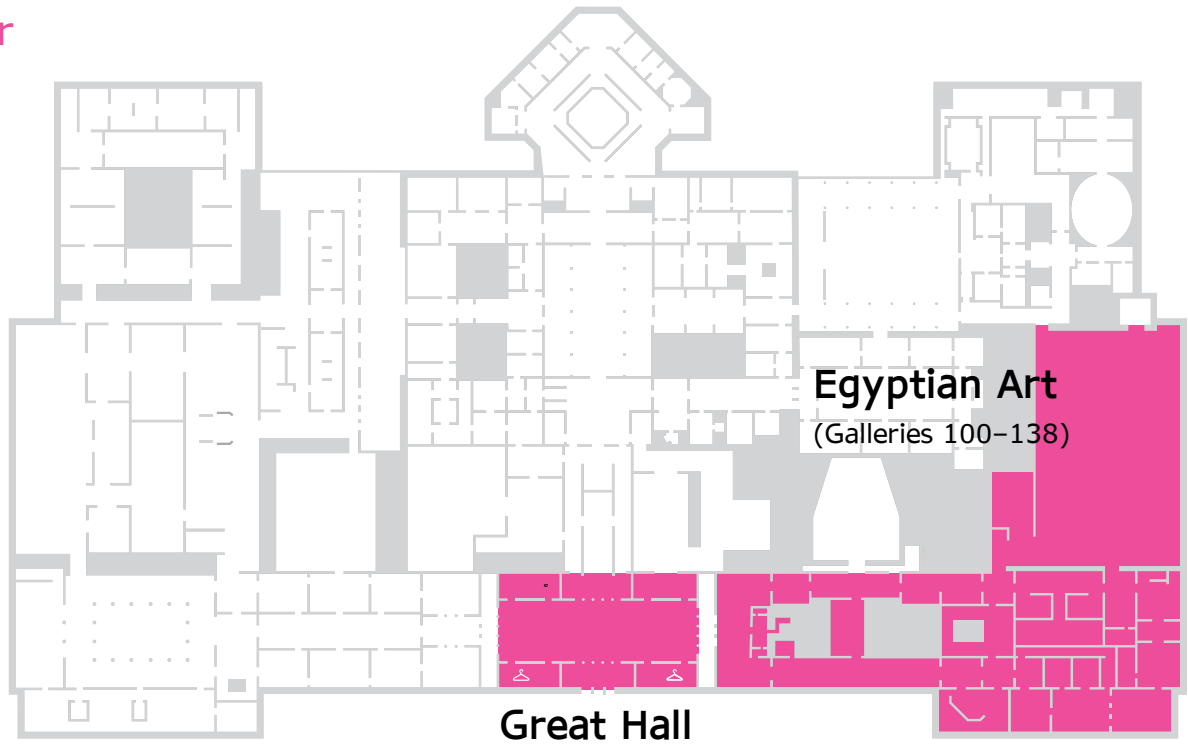

2nd floor



Spaces that can be loud

1st floor



2nd floor

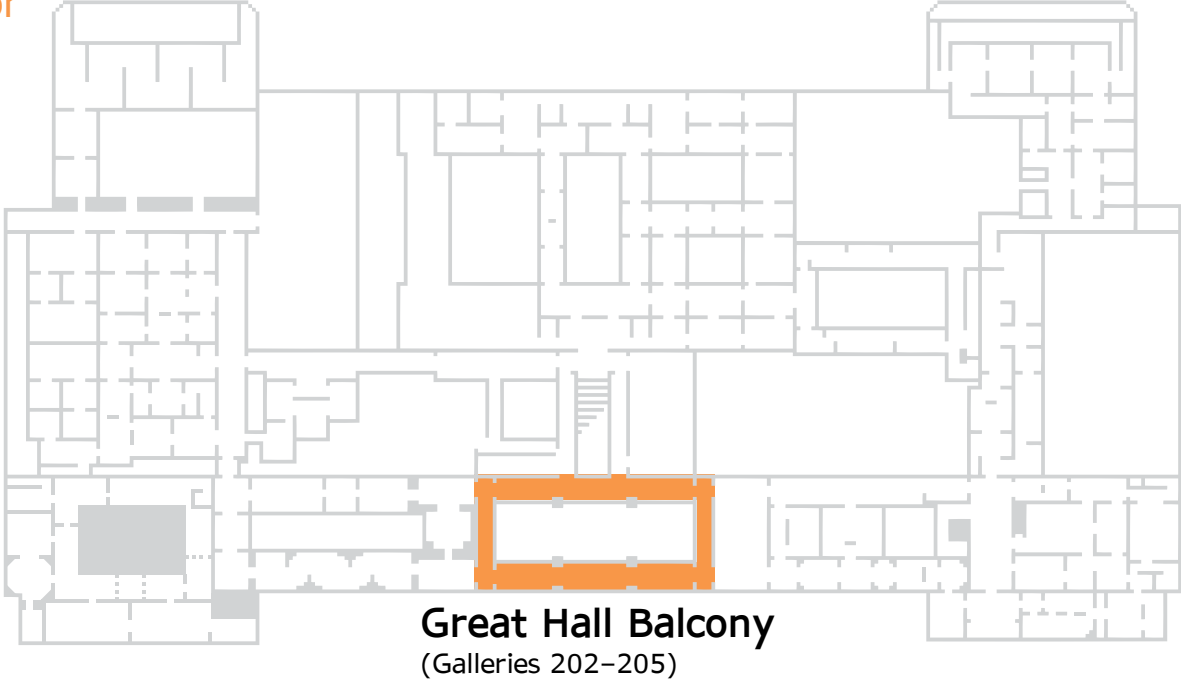

Spaces with natural light

1st floor

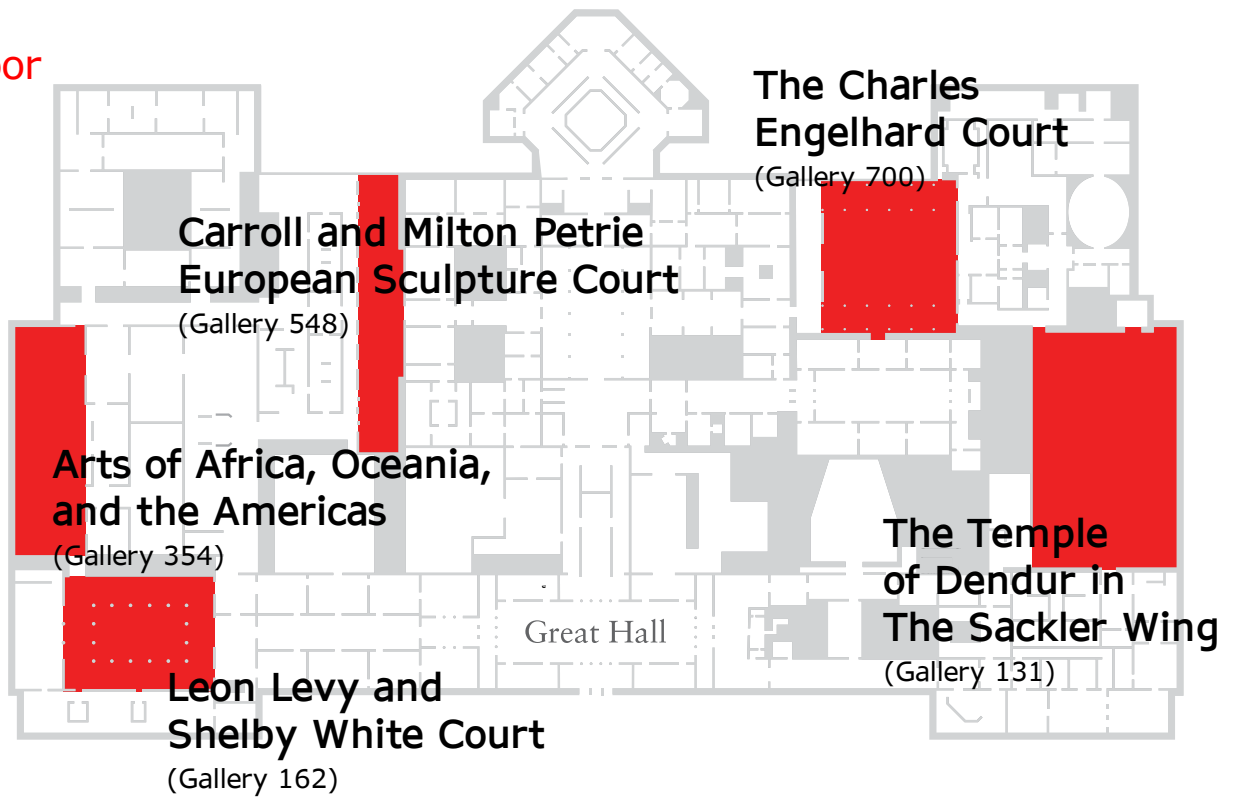

2nd floor

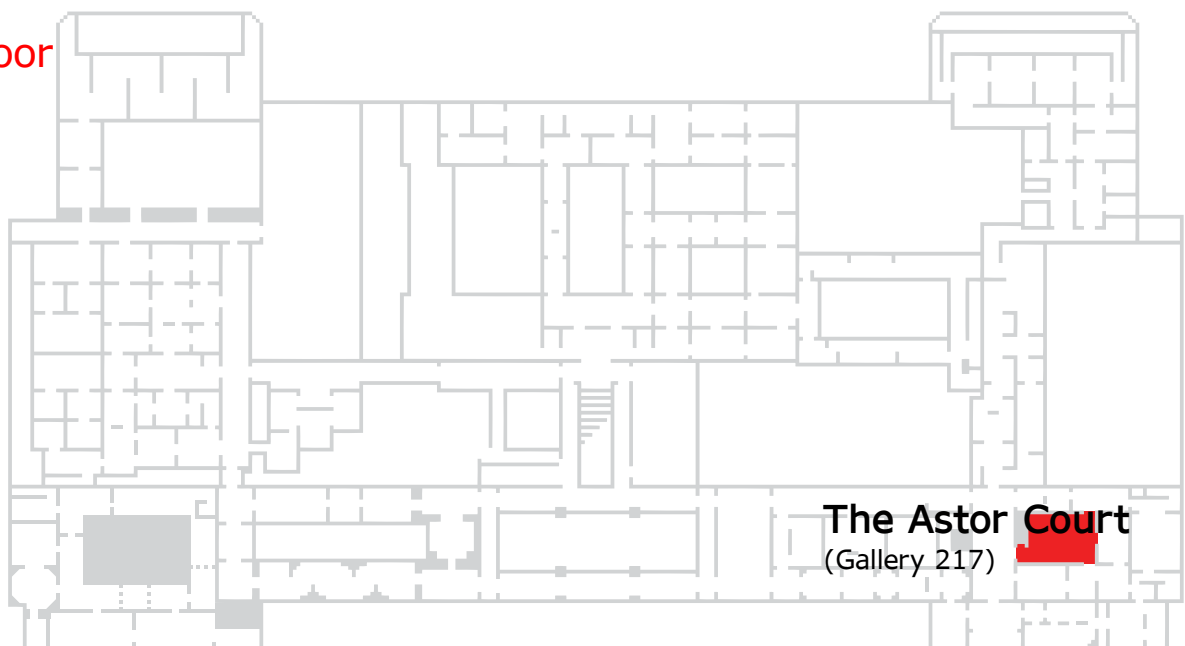

Spaces with low or subdued light

1st floor



2nd floor

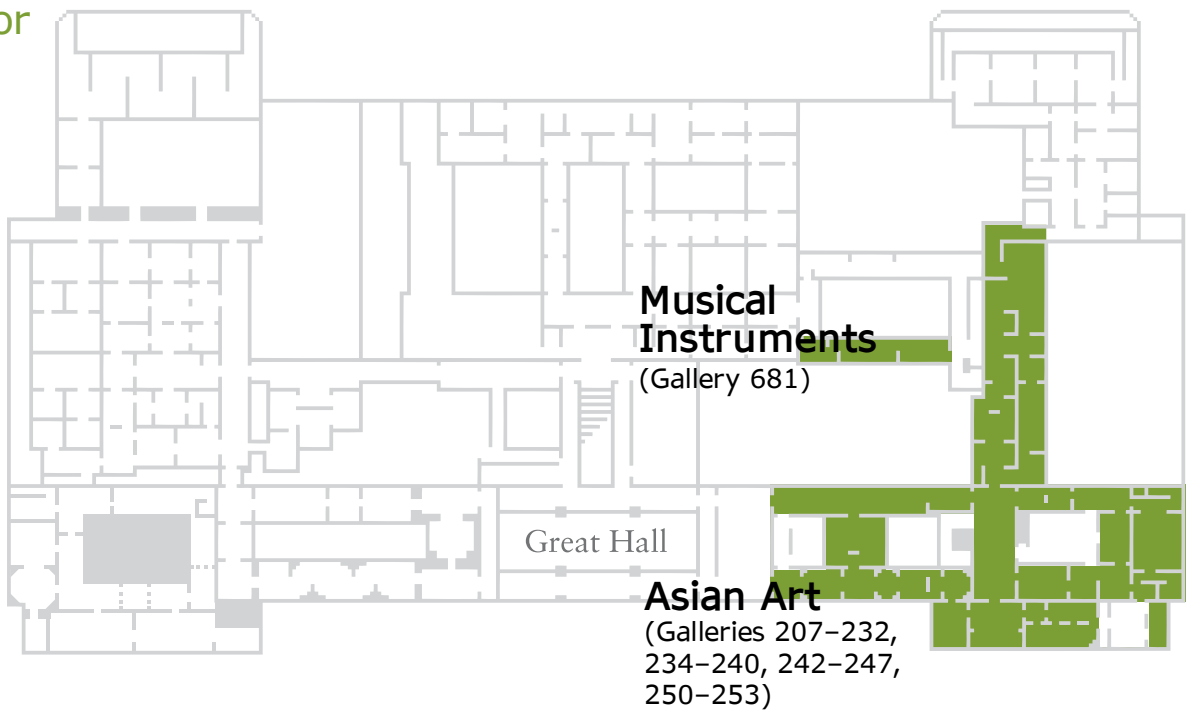

Access and Community Programs

Contact us for information about accessibility, accommodations, and programs for visitors with disabilities:

Telephone: (212) 650-2010

Email: access@metmuseum.org

Access and Community Programs

The Metropolitan Museum of Art

1000 Fifth Avenue

New York, NY 10028-0198

www.metmuseum.org/events/visitorsdisabilities



Join us on Facebook

Access Coordination at The Metropolitan Museum of Art

This resource was created in consultation with Autism Friendly Spaces.

Access Programs at The Metropolitan Museum of Art are made possible by **MetLife Foundation**.

Generous support also provided by the Filomen M. D'Agostino Foundation.

Also made possible by Estate of Doris Alperdt, Renate, Hans & Maria Hofmann Trust, Allene Reuss Memorial Trust, The Ceil & Michael E. Pulitzer Foundation, The Fan Fox & Leslie R. Samuels Foundation, Inc., Jane B. Wachsler, The J.M. Foundation, The Gordon and Llura Gund Foundation, gifts in memory of Lisa Merians DiSalvo, and The Murray G. and Beatrice H. Sherman Charitable Trust.